

**BASIC PRICING INFORMATION**

Area 1	5m x 2.0m	\$550pw	No power
Area 3	3.0m x 2.0m	\$550pw	No power
Area 4	4.0m x 2.0m	\$550pw	No power
Area 5	6.0m x 3.0m	\$550pw	No power
Area 6	4.0m x 5.0m	\$550pw	Power
Area 7	4.0m x 5.0m	\$550pw	Power
Area 8	4.0m x 1.8m	\$550pw	Power
Area 9	4.0m x 1.8m	\$550pw	Power
Area 10	2.0m x 1.8m	\$550pw	Power
Area 11	Carpark	\$550pw	No power

Monday to Sunday rate is \$660pw for all areas  
 Sunday Trade 11am - 5pm

Areas shown are for location identification only and are not to scale.

Prices include GST and are subject to change without notice.

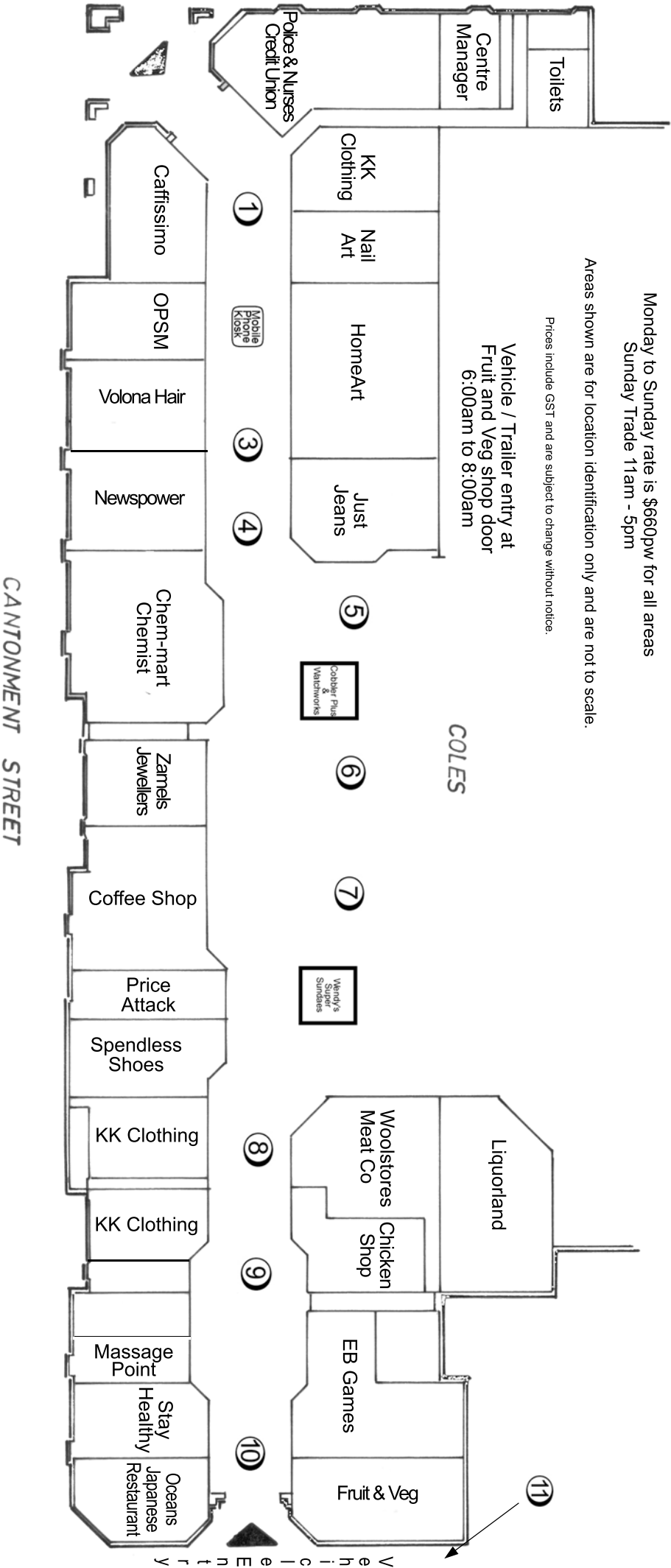

Woolstores Shopping Centre  
 Cantonment Street  
 Fremantle

**Casual Mall Leasing Floor Plan**

Updated 30/8/2011