

Lakeside Joondalup Centre Directory

Ground Floor West



- Area J 2m x 2m \$1100pw (NP)
- Area F3 7m x 5m \$2420pw
- Area F4 7m x 5m \$2420pw
- Area F5 7m x 5m \$2420pw
- Area F6 7m x 5m \$2420pw
- Area CC 4m x 3m \$1650pw

- Area SS1 3m x 3m \$1650pw
- Area SS2 3m x 3m \$1650pw
- Area SS3 2m x 2m \$1650pw (NP)
- Area WW 4m x 3m \$1650pw
- Area X1 5m x 3m \$1650pw
- Area X2 5m x 3m \$1650pw

NP denotes the site has no power
 Variable outgoing charges apply.
 \$5.50 incl GST per trading day.



LAKESIDE
 JOONDALUP SHOPPING CITY

Supa IGA

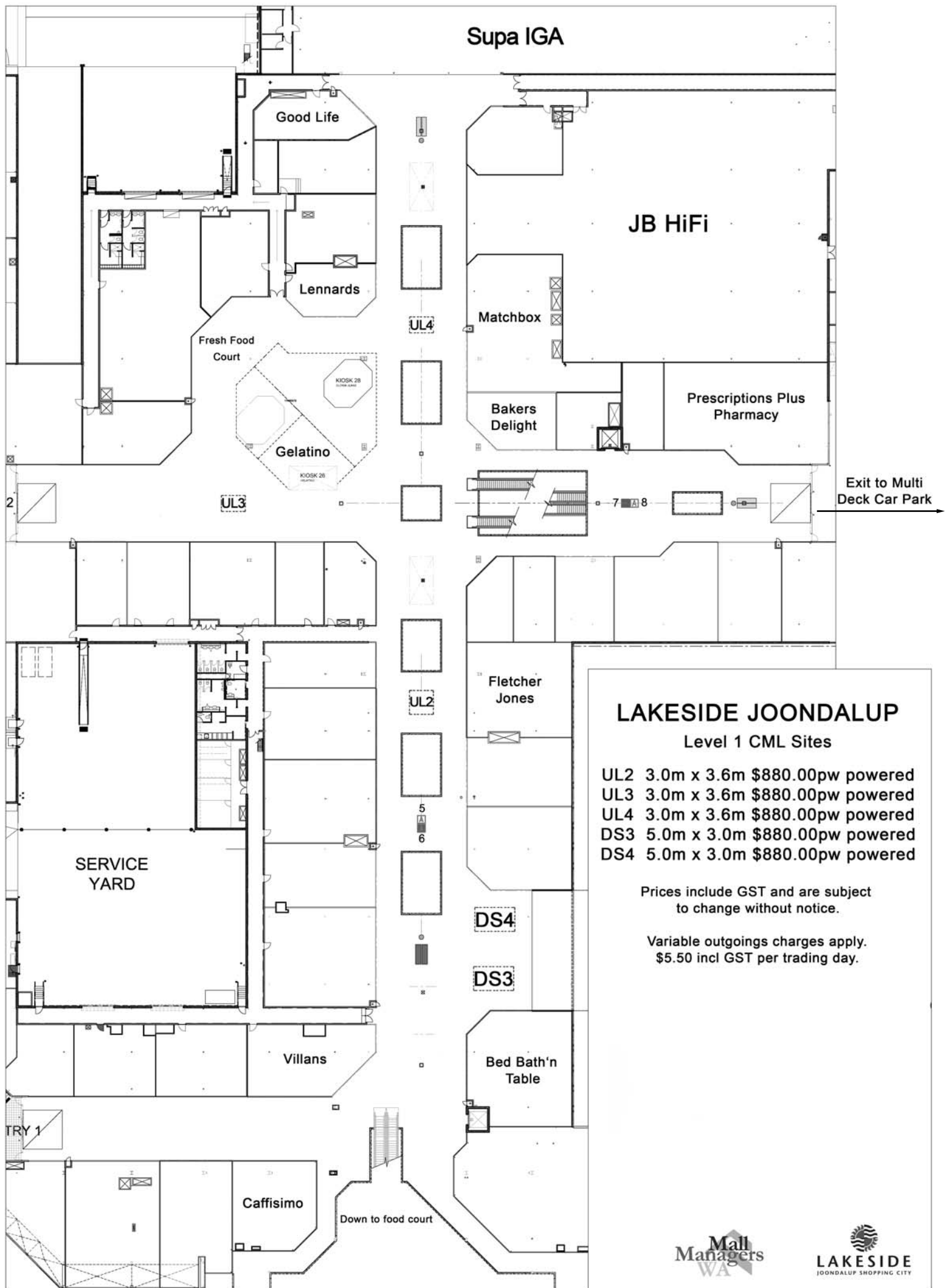

LAKESIDE JOONDALUP

Level 1 CML Sites

- UL2 3.0m x 3.6m \$880.00pw powered
- UL3 3.0m x 3.6m \$880.00pw powered
- UL4 3.0m x 3.6m \$880.00pw powered
- DS3 5.0m x 3.0m \$880.00pw powered
- DS4 5.0m x 3.0m \$880.00pw powered

Prices include GST and are subject to change without notice.

Variable outgoings charges apply.
\$5.50 incl GST per trading day.

Big W

Red Dot

Pumpkin Patch

[BW3]

Annas Cards & Gifts

Rebel Sport

[DIP & DOT]

Cotton On

[BW2]

ATM4

ATM3

Mazzucchelli's

[BW1A]

Katies

LAKESIDE JOONDALUP

Ground Floor East CML Sites

- BW1 3m x 2m \$1650.00 powered
- BW1A 3m X 2m \$1650.00 powered
- BW2 3m x 2m \$1650.00 powered
- BW3 3m x 2m \$1650.00 powered
- DS1 5m x 3m \$1650.00 powered
- DS2 5m x 3m \$1650.00 powered

Prices include GST and are subject to change without notice.

Variable outgoings charges apply. \$5.50 incl GST per trading day.

[BW1]

Scents

[DS2]

[DS1]

Food Court

Through to Kmart
Coles & Woolworths



